



Ray's Well Testing Service Inc.
 4853 Vine Hill Rd, Sebastopol Ca 95472
 Phone 707 823 3191 Fax 707 317 0057 Lic# 903708

CUSTOMER INFORMATION

REPORT #: 14490-1 By: Cody Monday	DATE OF TEST: 3/2/23
CUSTOMER NAME: Poppy Asset LLC	CONTACT:
AGENT NAME: Karl Bundensen - Sonoma Marin Ranches	CONTACT: 707 481 6500
PROPERTY ADDRESS: 2115 Adobe Rd, Petaluma CA	SENT TO: karl.bundensen@bundensen.com

WELL DATA

LOCATION OF WELL:	Back Well - Near large corrugated steel storage tank
TYPE OF WELL:	Drilled
DEPTH OF COMPLETED WELL:	280 Feet - per provided well log
DIAMETER OF WELL CASING:	8" PVC
SANITARY WELL SEAL (PLATE SEAL AT OPENING OF WELL CASING):	Yes
ANNULAR SEAL (IN-GROUND SEAL OF BOREHOLE):	50 Feet Cement - Per provided well log
PUMP HP AND TYPE:	15 HP 230V 3 Phase Submersible. #2-4 Sub Cable.
DEPTH OF PUMP SUCTION:	Unknown - please refer to installer records. 3" Galv Tee.

WATER PRODUCTION RESULTS

WATER LEVEL AT START (STATIC LEVEL):	51 Feet	FLOW RATE AT START:	102 GPM
FINAL PUMPING LEVEL:	81.5 Feet	FINAL FLOW RATE:	85 GPM
WATER LEVEL DRAWDOWN:	30.5 Feet	TOTAL LENGTH OF TEST:	4 Hours

CONSTANT PUMPING LEVEL INFORMATION

STABILIZED PUMPING LEVEL:	81.5 Feet	STABILIZED FLOW RATE (YIELD):	85 GPM
DURATION OF CONSTANT PUMPING LEVEL:	2 Hours 30 Minutes	TOTAL YIELD:	12,750 Gallons

WATER SYSTEM INSPECTION

WELL PUMP	Functional	TECHNICAL INFO: 102 GPM @ 130 PSI @ 51', 34.5/38.1/38.3 Amps
ELECTRICAL	Functional	TECHNICAL INFO: 100 Amp 3- pole breaker, sub panel located near well head
PRESSURE TANK	See Comments	TECHNICAL INFO: See Comments
STORAGE TANK	Not connected to well	TECHNICAL INFO: Not Observed
BOOSTER PUMP	None	TECHNICAL INFO:

WATER QUALITY TESTING

THE FOLLOWING SAMPLES ARE BEING ANALYZED. PLEASE REFER TO FOLLOW-UP REPORT FOR RESULTS.		
Basic Residential & Irrigation Package	DATED: 3/2/23	TURNAROUND: Standard
	DATED:	TURNAROUND:
	DATED:	TURNAROUND:
	DATED:	TURNAROUND:

SEE NEXT PAGE FOR FURTHER INFORMATION...

DATE: 3/2/23

ADDRESS: 2115 Adobe Rd, Petaluma CA

COMMENTS: Back Well

1. The recharge rate at the end of the test was 85 gallons per minute. This test may not represent the long term or seasonal yield.
2. The water was visibly clear for the duration of the test.
3. The water had a moderate sulfur odor for the first 30 minutes of the test, then the sulfur odor became mild for the remainder of the test.
4. The submersible well pump pressurizes an 86 gallon Well-X-Trol WX 302 pressure tank (tank dated N/A, 34 PSI air charge), 85 gallon Air-E-Tainer AT266 pressure tank (tank dated 2005, 31 PSI air charge) and an 85 gallon Flex 2 Pro WWT85 pressure tank (tank dated 2000, 0 PSI air charge). The operating pressure is set 45 to 55 PSI.
5. The technician was unable to verify what the well pump pressure system supplies in terms of distribution plumbing.
6. There is a large steel storage tank near the well head but it was not connected to the system was not inspected or tested.
7. There are two other wells on the property. For the well located near the front of the property please refer to report #14490-2 for the well yield and inspection report. The other well was not inspected or tested.

RECOMMENDATIONS:

1. The Air-E-Tainer pressure tank has failed, recommend replacement.
2. The check valve at the well head has failed, recommend replacement.
3. Both pressure gauges on the pressure system are illegible, recommend replacements.
4. The operating pressure is narrow, recommend readjusting range.
5. The pressure relief valve is located on the wrong side of the throttle valve, recommend relocating.
6. The water tests indicate elevated manganese. If the water is used for domestic purposes, then a water treatment system should be installed. We are partnered with Northcoast Waterworks and can provide a quote upon request.

Estimated costs of recommendations #1-5 per customer request: Total including labor, materials and tax \$2,810

Thank you for allowing us to do your well inspection!

APPROVED BY: NICK BRASESCO



Water levels and well depth are measured as feet below top of well casing unless otherwise noted.

All wells and springs are subject to seasonal and yearly changes in regards to water yield, production and quality. Wells may be influenced by creeks or other water sources and are likely to yield less water during dry months of the year; typically August, September, & October. We make no predictions of future water production or water quality.

This report is for informational use only and is in lieu of and supercedes any other representation or statements of the agent or employee of the company, and all other such representations or statements shall be relied upon at the customer's own risk. The data and conclusions provided herein are based upon the best information available to the company using standard and accepted practices of the water well drilling industry. However, conditions in water wells are subject to dramatic changes in short periods of time. Therefore, the data and conclusions are valid only as of the date of the test and should not be relied upon to predict either the future quantity or quality the well will produce. The company makes no warranties either expressed or implied as to future water production and expressly disclaims and excludes any liability for consequential or incidental damages arising out of the breach of any expressed or implied warranty of future water production or out of any further use of the report by the customer.

Well Head



Pressure Tanks



Sub Panel



NOT INSPECTED OR TESTED
Corrugated Steel Storage Tank



NOT INSPECTED OR TESTED
Old Well



The free Adobe Reader may be used to view and complete this form. However, software must be purchased to complete, save, and reuse a saved form.

Use Original with DWR

Well Completion Report

State of California
Refer to Instruction Pamphlet
No. 0056802

DWR Use Only - Do Not Fill In

057107W15

State Well Number/Site Number

Latitude Longitude

APN/TRS/Other

Page 1 of 1
Well Number 01
Date Work Began 06/18/2007 Date Work Ended 6/21/2007
Local Permit Agency SONOMA CO. PRMD
Permit Number WEL07-0253 Permit Date 6/21/07

Geologic Log

Orientation Vertical Horizontal Angle Specify _____
Drilling Method Direct Rotary Drilling Fluid Bentonite mud

Depth from Surface	Description
Feet to Feet	Describe material, grain size, color, etc
0 to 10	ADOBE TOPSOIL
10 to 110	BLUE SANDY CLAY
110 to 200	BLUE SANDSTONE W/ HARD STKS
200 to 220	BLUE VOLCANIC ROCK
220 to 240	MIXED BLUE VOLCANIC'S & CLAY
240 to 270	BLUE VOLCANIC'S
270 to 300	MIXED BLUE VOLCANIC'S & CLAY

Well Owner

Well Location

Address 2115 ADOBE RD. Old
City PETALUMA County Sonoma
Latitude _____ N Longitude _____ W
Datum _____ Decimal Lat. _____ Decimal Long. _____
APN Book 136 Page 130 Parcel 010
Township _____ Range _____ Section _____

Location Sketch

(Sketch must be drawn by hand after form is printed.)

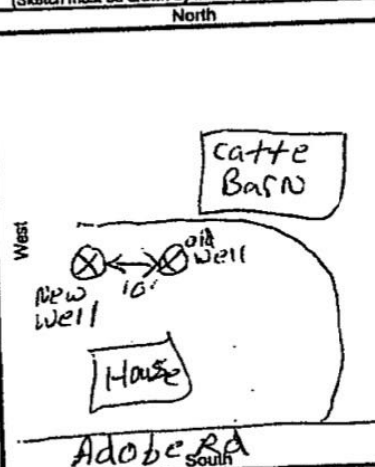

Activity

- New Well
 - Modification/Repair
 - Deepen
 - Other
 - Destroy
- Describe procedures and materials under "GEOLOGIC LOG"

Planned Uses

- Water Supply
 - Domestic Public
 - Irrigation Industrial
- Cathodic Protection
- Dewatering
- Heat Exchange
- Injection
- Monitoring
- Remediation
- Sparging
- Test Well
- Vapor Extraction
- Other

Illustrate or describe distance of well from roads, buildings, fences, rivers, etc. and attach a map. Use additional paper if necessary. Please be accurate and complete.

Water Level and Yield of Completed Well

Depth to first water 110 (Feet below surface)
Depth to Static _____
Water Level 80 (Feet) Date Measured 06/21/2007
Estimated Yield * 200+ (GPM) Test Type Constant Rate
Test Length 4.0 (Hours) Total Drawdown 275 (Feet)
*May not be representative of a well's long term yield.

Casings

Depth from Surface	Borehole Diameter	Type	Material	Wall Thickness	Outside Diameter	Screen Type	Slot Size
Feet to Feet	(Inches)			(Inches)	(Inches)		If Any (Inches)
0 to 100	14.75	Blank	PVC Sch. 80	200	8	N/A	0.000
100 to 280	14.75	Screen	PVC Sch. 80	200	8	Milled Slots	0.032

Annular Material

Depth from Surface	Fill	Description
Feet to Feet		
0 to 50	Cement	6 SAC 3/8'S
50 to 300	Filter Pack	#6 (8-16) SAND

Attachments

- Geologic Log
- Well Construction Diagram
- Geophysical Log(s)
- Soil/Water Chemical Analyses
- Other

Certification Statement

I, the undersigned, certify that this report is complete and accurate to the best of my knowledge and belief

Name KOENIG ENTERPRISES WATER WELL DRILLING
Person, Firm or Corporation SEBASTOPOL CA 95472
4845 HESSEL RD City State Zip
Signed _____ Date Signed 06/21/07 786191
C-57 Licensed Water Well Contractor C-57 License Number